

RIVERBEND COMMERCE CENTER



26511 79TH AVE S | BLDG C | KENT, WA



BRIAN BRUININKS, CCIM
(206) 856-6249
bbruininks@andoverco.com

SHANE MAHVI, SIOR
(858) 442-0441
smahvi@andoverco.com

21,622 SF

RIVERBEND COMMERCE CENTER

26511 79TH AVE S | BLDG C | KENT, WA



PROPERTY HIGHLIGHTS

- Total Space: 21,622 SF
- Office Space: 3,720 SF
 - 1,048 SF (North end office)
 - 2,682 SF on two floors (West end office)
- 8 dock high doors
- 2 grade level doors
- Available with 30-60 days notice

BRIAN BRUININKS, CCIM
(206) 856-6249
bbruininks@andoverco.com

SHANE MAHVI, SIOR
(858) 442-0441
smahvi@andoverco.com

The information contained herein has been obtained from reliable sources, but is not guaranteed. A prospective buyer/tenant should verify each item relating to this property and all information contained herein.

RIVERBEND BUILDING | KENT, WA



BUILDING C

21,622 SF

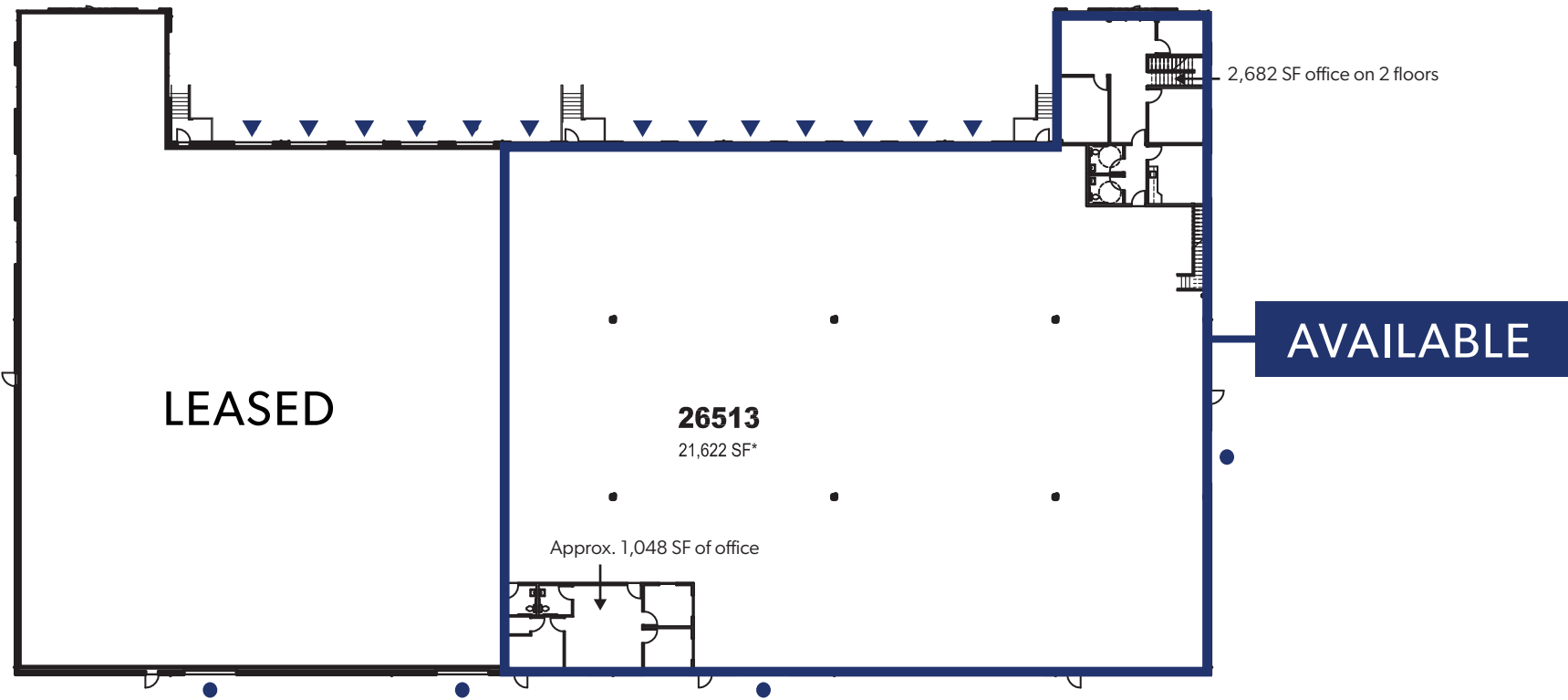
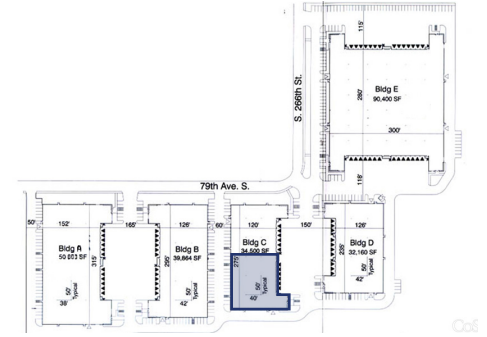

▲ Dock High Door

● Grade Level Door





BRIAN BRUININKS, CCIM
(206) 856-6249
bbruininks@andoverco.com

SHANE MAHVI, SIOR
(858) 442-0441
smahvi@andoverco.com



RIVERBEND COMMERCE CENTER

26511 79TH AVE S | BLDG C | KENT, WA